

ASSEMBLING INSTRUCTION

CRASH PAD KIT

HP6101-24

WWW.BARRACUDAMOTO.COM

LEGEND

- | | | |
|---------------------------------------------------------------------------------------------------------------------------------------|---------------------------------------------------------------------------------------------------------------------------------------|--------------------------------------------------------------------------------------------------------|
| 1. CRASH PAD KIT
KIT TAMPONE
TOPES ANTICAIDA
STURZPADS
KIT TAMPON | 4. SPECIFIC BRACKET
STAFFA SPECIFICA
SOPORTE ESPECIFICO
SPEZIFISCHE KLAMMER
SUPPORT SPÉCIFIQUE | 7. SPACER TUBE H. 20
DISTANZIALE H. 20
DISTANCIADOR H. 20
DISTANZROHR H. 20
ESPACEUR H. 20 |
| 2. ADESIVO QUADRATO 20X20
ADHESIVE SQUARE 20X20
CUADRADO ADHESIVO 20X20
KLEBEFLÄCHE 20X20
CARRÉ ADHÉSIF 20X20 | 5. SPACER TUBE H. 13
DISTANZIALE H. 13
DISTANCIADOR H. 13
DISTANZROHR H. 13
ESPACEUR H. 13 | |
| 3. HEXAGONAL BOLT M12X80
BULLONE ESAGONALE M12X80
PERNO HEXAGONAL M12X80
SECHSKANTSCHRAUBE M12X80
BOULON HEXAGONAL M12X80 | 6. HEXAGONAL BOLT M12X90
BULLONE ESAGONALE M12X90
PERNO HEXAGONAL M12X90
SECHSKANTSCHRAUBE M12X90
BOULON HEXAGONAL M12X90 | |

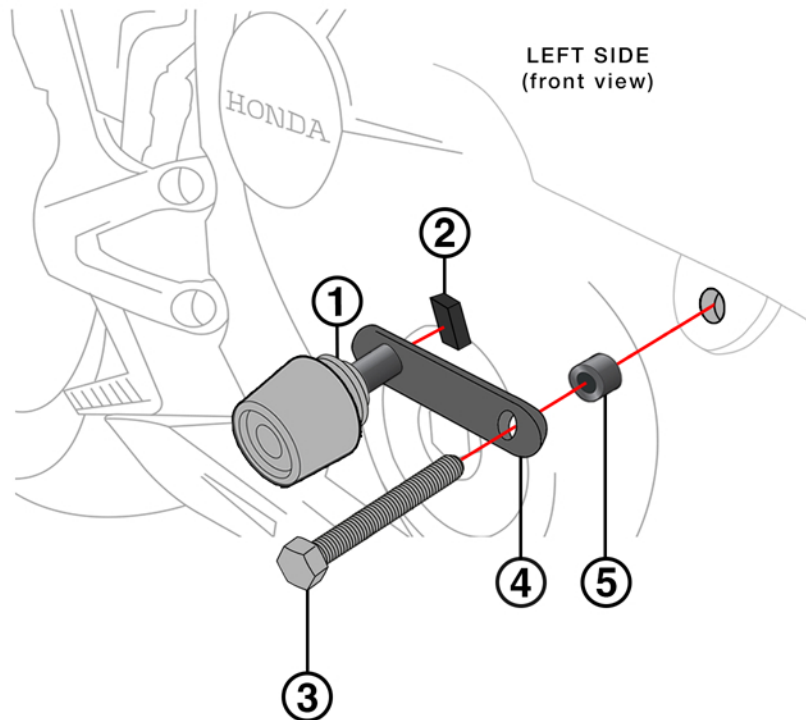
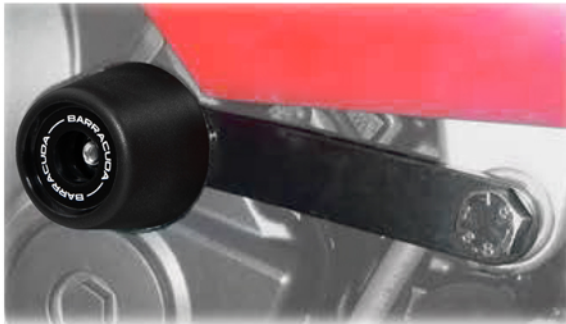

RIGHT SIDE
(front view)

